

RYOBI®

ORIGINAL INSTRUCTIONS

18V ONE+ Hybrid Radio

R18HR



Important!

It is essential that you read the instructions in this manual before assembling, operating and maintaining the product.

Subject to technical modification.

Safety, performance, and dependability have been given top priority in the design of your radio.

INTENDED USE

The product is intended for:

- listening to FM/AM radio, MP3 players, and other audio devices
- charging USB capable devices
- streaming audio from BLUETOOTH® enabled devices

Do not use the product in any way other than those stated for intended use.

GENERAL SAFETY WARNINGS

WARNING

Read all safety warnings and all instructions. Failure to follow the warnings and instructions may result in electric shock, fire and/or serious injury.

- Do not use the product near water.
- Clean only with dry cloth. Never use brake fluids, gasoline, petroleum-based products, or any strong solvents to clean the product. Following the rule will reduce the risk of loss of control and deterioration of the enclosure plastic.
- Do not block any ventilation openings. Install in accordance with the manufacturer's instructions.
- Do not place the product in closed bookcases or racks without proper ventilation. Allow a minimum distance of 5 cm from any foreign object.
- Do not place product near any heat sources such as radiators, heat registers, stoves, or other products (including amplifiers) that produce heat.
- Only use attachments and accessories specified by the manufacturer.
- Refer all servicing to qualified service personnel. Servicing is required when the product has been damaged in any way, liquid has been spilled or objects have fallen into the product, the product has been exposed to rain or moisture, does not operate normally, or has been dropped.
- When servicing the product, use only manufacturer's replacement parts, accessories and attachments. Follow instructions in the Maintenance section of the manual. Use of unauthorized parts or failure to follow Maintenance instructions may create a risk of shock or injury.
- Know your product. Read operator's manual carefully. Learn its applications and limitations, as well as the specific potential hazards related to the product. Following the rule will reduce the risk of electric shock, fire, or serious injury.

- Do not operate the product in explosive atmospheres, such as in the presence of flammable liquids, gases, or dust. The product may create sparks that may ignite the dust or fumes.

ELECTRICAL SAFETY

- A battery operated product with integral batteries or a separate battery pack must be recharged only with the specified charger for the battery. A charger that may be suitable for one type of battery may create a risk of fire when used with another battery.
- Use battery operated product only with specifically designated battery pack. Use of any other batteries may create a risk of fire.
- Use 18 V lithium-ion battery packs.

WARNING

Danger of explosion if battery is incorrectly replaced. Replace only with the same or equivalent type.

PERSONAL SAFETY

- Do not use the product to listen to music or other audio programs while operating machinery. Doing so may cause distractions that could result in serious personal injury.
- The product is capable of producing sound levels that can be dangerous to long-term hearing. Listening to music at high volume for any period of time may cause noise-induced hearing loss. The higher the volume, the less time required before your hearing may be affected.

PRODUCT USE AND CARE

- When battery pack is not in use, keep it away from other metal objects like paper clips, coins, keys, nails, screws, or other small metal objects that can make a connection from one terminal to another. Shorting the battery terminals together may cause sparks, burns, or a fire.
- Keep the product dry, clean and free from oil and grease. Always use a clean cloth when cleaning.
- Battery products do not have to be plugged into an electrical outlet; therefore, they are always in operating condition. Be aware of possible hazards when not using your battery product or when changing accessories. Following the rule will reduce the risk of electric shock, fire, or serious personal injury.
- Do not place battery products or their batteries near fire or heat. This will reduce the risk of explosion and possibly injury.
- Do not crush, drop or damage battery pack. Do not use a battery pack or charger that has been dropped or received a sharp blow. A damaged battery is subject to explosion. Properly dispose of a dropped or damaged battery immediately.
- Batteries can explode in the presence of a source

of ignition, such as a pilot light. To reduce the risk of serious personal injury, never use any cordless product in the presence of open flame. An exploded battery can propel debris and chemicals. If exposed, flush with water immediately.

- Do not charge battery product in a damp or wet location. Following the rule will reduce the risk of electric shock.
- For best results, your battery product should be charged in a location where the temperature is more than 10°C but less than 38°C. To reduce the risk of serious personal injury, do not store outside or in vehicles.
- Risk of uncontrolled situations when used in ambient temperatures below 0°C or above 40 °C.
- Under extreme usage or temperature conditions, battery leakage may occur. If liquid comes in contact with your skin, wash immediately with soap and water. If liquid gets into your eyes, flush them with clean water for at least 10 minutes, then seek immediate medical attention. Following the rule will reduce the risk of serious personal injury.
- To reduce the risk of personal injury and electric shock, the product should not be played with or placed where small children can reach it.
- Save these instructions. Refer to them frequently and use them to instruct others who may use this product. If you loan someone this product, loan them these instructions also.
- Do not dispose of used battery packs in the household refuse or by burning them. Take them to an appropriate disposal/collection site.
- The apparatus shall not be exposed to dripping or splashing and that no objects filled with liquids, such as vases, shall be placed on the apparatus.
- Batteries (battery packs or batteries installed) shall not be exposed to excessive heat such as sunshine, fire and the like.
- The appliance employs an appliance coupler as the disconnect device from mains supply. The disconnect device shall remain readily operable.

ADDITIONAL SAFETY WARNINGS

WARNING

The product is not intended for use by persons (including children) with reduced physical, sensory or mental capabilities, or lack of experience and knowledge, unless they have been given supervision or instruction concerning use of the product by a person responsible for their safety.

Children should be supervised to ensure that they do not play with the product.

ADDITIONAL BATTERY SAFETY WARNINGS

WARNING

To reduce the risk of fire, personal injury, and product damage due to a short circuit, never immerse your tool, battery pack or charger in fluid or allow a fluid to flow inside them. Corrosive or conductive fluids, such as seawater, certain industrial chemicals, and bleach or bleach-containing products, etc., can cause a short circuit.

- Replacement of a battery with an incorrect type can defeat a safeguard.
- Disposal of a battery into fire or a hot oven, or mechanically crushing or cutting of a battery, can result in an explosion.
- Leaving a battery in an extremely high temperature surrounding environment can result in an explosion or the leakage of flammable liquid or gas.
- A battery subjected to extremely low air pressure may result in an explosion or the leakage of flammable liquid or gas.

TRANSPORTING LITHIUM BATTERIES

Transport the battery in accordance with local and national provisions and regulations.

Follow all special requirements on packaging and labelling when transporting batteries by a third party. Ensure that no batteries can come in contact with other batteries or conductive materials while in transport by protecting exposed connectors with insulating, non-conductive caps or tape. Do not transport batteries that are cracked or leaking. Check with the forwarding company for further advice.

ASSEMBLY

WARNING

Do not use the product if it is not completely assembled or if any parts appear to be missing or damaged. Use of a product that is not properly and completely assembled or with damaged or missing parts could result in serious personal injury.

WARNING

Do not attempt to modify the product or create accessories or attachments not recommended for use with the product. Any such alteration or modification is misuse and could result in a hazardous condition leading to possible serious personal injury.

OPERATION

WARNING

Do not allow familiarity with the product to make you careless. Remember that a careless fraction of a second is sufficient to inflict serious injury.

WARNING

Always remove the battery pack from the product when you are assembling parts, cleaning, or when not in use. Removing these energy sources will prevent accidental starting that could cause serious personal injury.

WARNING

The product is not waterproof. Do not submerge in liquid. Failure to heed this warning could result in serious personal injury.

CAUTION

Always refer to the manual for any device recommended for use as an attachment or accessory. Proper use of any device, when attached to the product, is the sole responsibility of the operator. Improper use may damage the device or the product.

WARNING

The product is capable of producing sound levels that can be dangerous to long-term hearing. Listening to music at high volume for any period of time can cause noise-induced hearing loss. The higher the volume, the less time required before your hearing could be affected.

INSTALLING/REMOVING AAA BATTERIES

See figure 1.

It is advisable to write down saved channels before replacing the AAA batteries.

There is a 15-second time frame for replacing the AAA batteries. If the batteries are not replaced within 15 seconds, the product will lose all settings previously stored in memory, and they will require reprogramming.

Always use new alkaline batteries for replacement.

1. Remove the battery pack, if installed.
2. Loosen the screw in the battery cover. Remove the cover and set aside.
3. Install two new AAA batteries according to polarity indicators inside the battery compartment.

NOTE: Do not mix old and new batteries. Do not mix alkaline, standard (carbon-zinc), or rechargeable (nickel-cadmium) batteries.

4. Replace the battery cover and tighten screw to secure.

INSTALLING/REMOVING BATTERY PACK

See figure 2.

To install the battery pack:

1. Place the battery pack in the product, aligning the rib on the battery pack with the groove in the battery port.
2. Make sure the latches on the battery pack snap into place and the battery pack is secured to the product before beginning operation.
3. Depress the latches to remove the battery pack.

NOTE: Always remove the battery pack from radio when not in use. Leaving the battery pack connected for long periods of time may drain the battery pack.

INSTALLING/REMOVING POWER CORD

See figure 2.

1. Push the on/off button to switch off the product.
2. Depress the latches on both sides to release the battery pack from the product.
3. Insert the female end of the power cord into the product as shown.
4. Connect the male end of the power cord to the power source.
5. Make sure the power cord is secured before beginning operation.

LCD DISPLAY

See figure 3.

When a battery pack is installed and the product is in the ON position, the LCD display will show the time, frequency, mode, and settings. When the battery pack is removed and AAA batteries are installed, the LCD display will display the time only.

NOTE: The illustrations of the LCD display shown in the manual are only examples of the frequencies you may see on your radio and are not the exact frequencies that you may choose to listen to.

MENU NAVIGATION BUTTONS

Use the menu navigation buttons to turn the product on and off, control the volume, change frequencies, toggle between modes and set the time.

SWITCHING THE PRODUCT ON AND OFF

See figure 3.

Press  to switch the product on and off.

NOTE: You may need to keep the button pressed for up to 3 seconds before the product will start. If this happens, replace the AAA batteries.

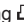
NOTE: When the product is on and a battery pack is installed,  will be shown in the LCD display. If the battery charge is low, a flashing  will be displayed.



To help preserve battery power, the product will automatically enter sleep mode approximately 1 hour after it is turned off. To exit sleep mode and restart the product, you must press **U** on the product.

MODE SELECTION

See figure 3.

- Press **MODE** to cycle through available modes.

There are four modes to choose from:

- FM mode
- AM mode
- AUX mode
- BLUETOOTH® mode

ADJUSTING THE VOLUME

See figure 3.

When the product is switched on, the product will return to the last volume setting used.

NOTE: If the AAA batteries are removed from the product or have no charge, the volume will return to its default settings.

- To increase the volume, press **▲**.
- To decrease the volume, press **▼**.

NOTE: To change volume quickly, hold **▲** or **▼**.

CAUTION

Do not use the product at maximum volume for an extended period of time with the bass and treble at maximum levels. It could cause damage to the speakers and/or amplifiers in the product.

FM/AM TUNING

See figure 3.

Use **◀** and **▶** to tune to the desired radio frequency. The selected frequency is displayed on the LCD display.

To tune frequency manually:

Briefly push either **◀** or **▶** (not press and hold) to tune one frequency step at a time.

1. Press and release **◀** to tune to a lower frequency.
2. Press and release **▶** to tune to a higher frequency.

To tune frequency automatically:

1. Press and hold **◀** or **▶** for one second to tune frequency automatically.
2. Press **◀** or **▶** to stop scanning and select a frequency.

To decrease interference or electrical noise, adjust the position of the antenna or move the product to a higher elevation.

STORING A PRESET IN MEMORY

See figure 3.

The memory feature saves up to 20 frequencies as presets in the product's memory. You can save up to 10 frequencies each for FM and AM modes.

To store a frequency in memory:

1. Tune to the desired FM or AM frequency.
2. Press and hold **PRESET** until "MEMORY" and the preset position number flash on the screen.
3. Press **◀** and **▶** to choose a preset position number.
NOTE: There are 10 preset positions for FM and 10 for AM. Only one station can be saved in each preset position.
4. Press **PRESET** again to store the frequency.

To tune to presets (FM or AM mode):

- Press and release **PRESET** to cycle through each preset position number and its associated frequency.

EQUALIZER FUNCTION

To adjust the bass and/or treble settings:

1. Press and hold **MODE** until "b" (BASS) is displayed. Press again and "t" (TREBLE) is displayed.
2. Press **▲** or **▼** until the desired bass or treble level (-5 to 5) is achieved. Press **MODE** to store your selection.

SETTING THE CLOCK

See figure 3.

Press **CLOCK** to view the frequency in the digital display for 10 seconds. The display will return to the current time after 10 seconds.

NOTE: In all modes, the time is the default display.

To set the clock:

1. Press and hold **CLOCK** until the hour time blinks.
2. Press **▲** or **▼** to select the hour.
3. Press and release **CLOCK** to lock in the hour setting. Minute time blinks.
4. Press **▲** or **▼** to select the desired minute.
5. Press and release **CLOCK** again to confirm the time. The clock is now set.



NOTE: If AAA batteries are removed or lose charge for more than 15 seconds, clock settings will be lost. Settings are not affected by the removal of the 18 V battery.

AUXILIARY MODE

See figure 3, 4.

The product can be used as an amplifier for MP3 players, CD players, smartphones, tablets, and other music devices.

To use the auxiliary mode:

1. Press **MODE** until **AUX** mode is highlighted.
2. Connect auxiliary cable (not included) to the device.
3. Connect the other end of the auxiliary cable to the auxiliary input port.

NOTE:

- The external device must be on and in play mode for sound to be heard through the speakers.
 - All external device controls can be used normally while connected to radio.
 - Volume for any device connected through the auxiliary cable can be adjusted using the volume control for that device or by using \blacktriangle or \blacktriangledown of the product.
 - Switching the product off will not switch the external device off.
 - The auxiliary cable does not provide charging function.
4. For complete operating instructions for the connected device, always refer to the manual that was included with your device.

The device tray may be used to store your external device.

NOTE: The device tray cannot secure external devices.

NOTE: The AUX OUT port is for connecting external speakers only. Do not plug headphones into the auxiliary output port. The volume for this port is set to maximum level and cannot be lowered with pressing \blacktriangledown . Volume can be adjusted from the external speaker only. When the volume is set to 0 from the radio, the external speaker will be mute.

USING THE USB DEDICATED CHARGING PORT

See figure 5.

The USB dedicated charging port provides charging power of up to 2 Amps for your cell phone, MP3 player, tablet, or other USB devices.

CAUTION

Attempting to charge devices rated more than 2 Amps could damage the USB dedicated charging port and/or the device.

1. Connect one end of a USB cable (not provided) to your

USB device.

2. Connect the other end of the USB cable (not provided) to the USB dedicated charging port to begin charging the device.

NOTE: The USB dedicated charging port provides power only; it does not provide any data communication capabilities.

When the product is operating on battery power, the USB dedicated charging port will continue to function for approximately 1 hour after switching the product off. If the product remains inactive after this time, charging will stop. Turn the product on to resume operation.

USING A BLUETOOTH® ENABLED DEVICE (NOT INCLUDED) WITH THE PRODUCT

See figure 6.

1. Press **MODE** until the BLUETOOTH® mode is highlighted.

NOTE:

- When the product is switched to BLUETOOTH® mode, the product will attempt to pair to a BLUETOOTH® enabled device and **bt** will flash in the LCD display.
 - The product will automatically attempt to connect to the last device it was paired to. If a connection cannot be established within five seconds, the product will make itself available to other BLUETOOTH® enabled devices.
 - BLUETOOTH® enabled devices must be within 10m (30 ft) of the product and set to search/scan in order to pair with the product.
2. Select "Ryobi Stereo" from your device's list of available BLUETOOTH® signals to pair the device and the product. No password or PIN is required for connection.

NOTE:

- When the device has successfully paired with the radio, **bt** will stop flashing.
 - When a device is paired to the product, information for connecting to the device is saved in the radio's memory.
3. Press \blacktriangleleft and \blacktriangleright to go to the previous or next track when streaming audio from a BLUETOOTH® enabled device.
 4. Press and release **PRESET** to cycle between pausing and playing the audio.

NOTE:

- These controls may not be supported by the BLUETOOTH® device and application.
- All BLUETOOTH® enabled device controls can be used normally while paired to the product.
- Volume for any device paired to the product can be adjusted using the volume control for that device or

by pressing  or  on the product.

- Press and hold **PRESET** to disconnect all BLUETOOTH® enabled device.

NOTE: When the device is disconnected, **bt** will begin flashing in the LCD display and the product will begin searching for another device.

FOLD-DOWN FLEXIBLE ANTENNA

See figure 7.

To decrease interference or electrical noise, extend the antenna or move the product to a higher elevation. The antenna folds down and out of the way when not in use.

MAINTENANCE

WARNING

Always remove the battery pack from the product and disconnect from the power supply when you are assembling parts, cleaning, or when not in use. Removing battery pack or unplugging extension cord will prevent accidental starting that could cause serious personal injury.

- Avoid using solvents when cleaning plastic parts. Most plastics are susceptible to damage from various types of commercial solvents and can be damaged by their use. Use dry cloths to remove dirt, dust, oil, grease, etc.

WARNING

Do not at any time let brake fluids, gasoline, petroleum-based products, penetrating oils, etc., come in contact with plastic parts. Chemicals can damage, weaken or destroy plastic which could result in serious personal injury.

When servicing, use only original manufacturer's replacement parts. Use of any other part could create a hazard or cause product damage.

ENVIRONMENTAL PROTECTION



Recycle raw materials instead of disposing of as waste. The machine, accessories and packaging should be sorted for environmental-friendly recycling.

SYMBOLS



Safety Alert



Regulatory Compliance Mark (RCM). Product meets applicable regulatory requirements.



Please read the instructions carefully before starting the product.



Class II equipment



Risk of electric shock



Do not expose to rain or use in damp locations.



To reduce the risk of electrocution or electric shock, keep away from water and do not use with damaged power cord.



Do not plug headphones into the auxiliary output port.



Waste electrical products should not be disposed of with household waste. Please recycle where facilities exist. Check with your local authority or retailer for recycling advice.

SYMBOLS IN THIS MANUAL



Parts or accessories sold separately

The following signal words and meanings are intended to explain the levels of risk associated with this product:

DANGER

Indicates an imminently hazardous situation, which, if not avoided, will result in death or serious injury.

WARNING

Indicates a potentially hazardous situation, which, if not avoided, could result in death or serious injury.

CAUTION

Indicates a potentially hazardous situation, which, if not avoided, may result in minor or moderate injury.

CAUTION

(Without Safety Alert Symbol) Indicates a situation that may result in property damage.

1. AAA batteries
2. Fold-down antenna
3. Touchpad controls
4. Carrying handle
5. Device tray
6. AC power plug
7. Battery port
8. Battery cover
9. Speakers
10. Auxiliary output port
11. Backlit LCD display
12. USB dedicated charging port
13. Auxiliary input port
14. Battery compartment
15. Screw
16. Battery pack

17. Latches
18. Extension cord
19. Clock settings button
20. Mode selection display
21. Battery pack indicator
22. On / Off button
23. Preset station button
24. Volume buttons
25. Frequency scan buttons
26. Mode selection button
27. Bass display
28. Treble display
29. External device (not included)
30. USB cable (not included)
31. Auxiliary connector

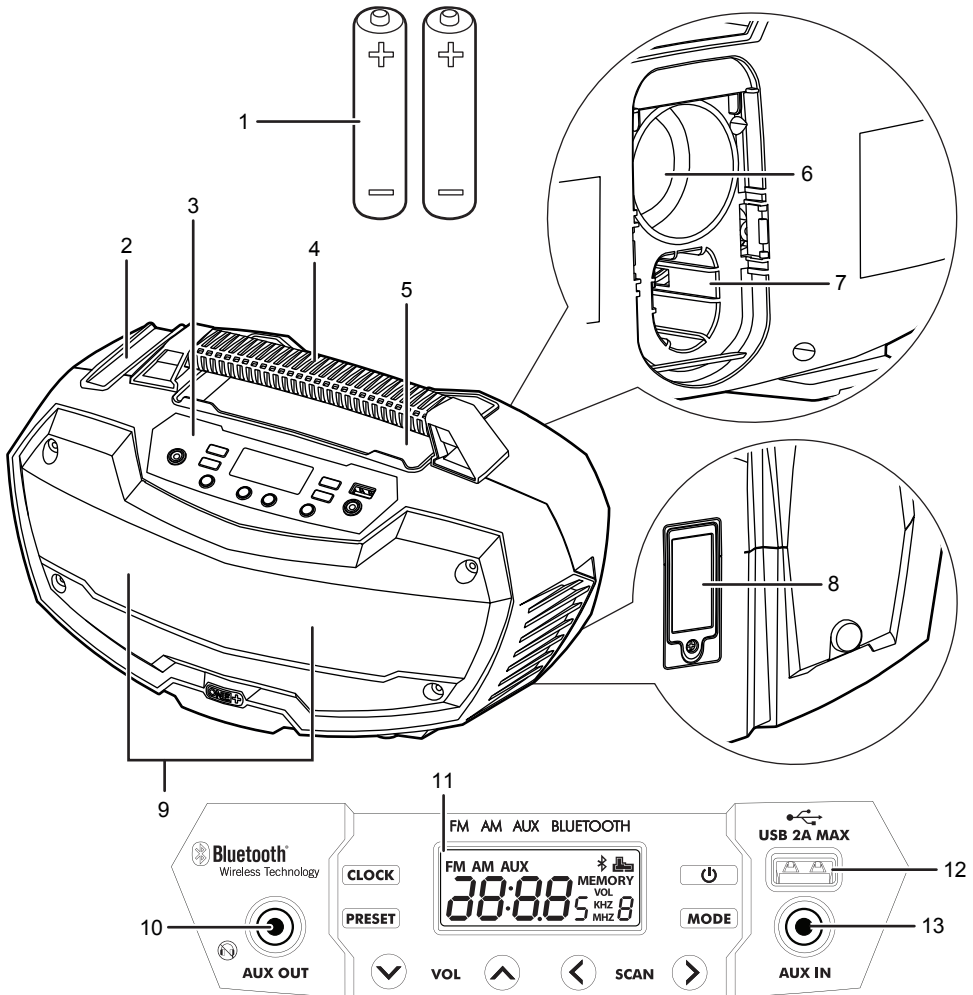

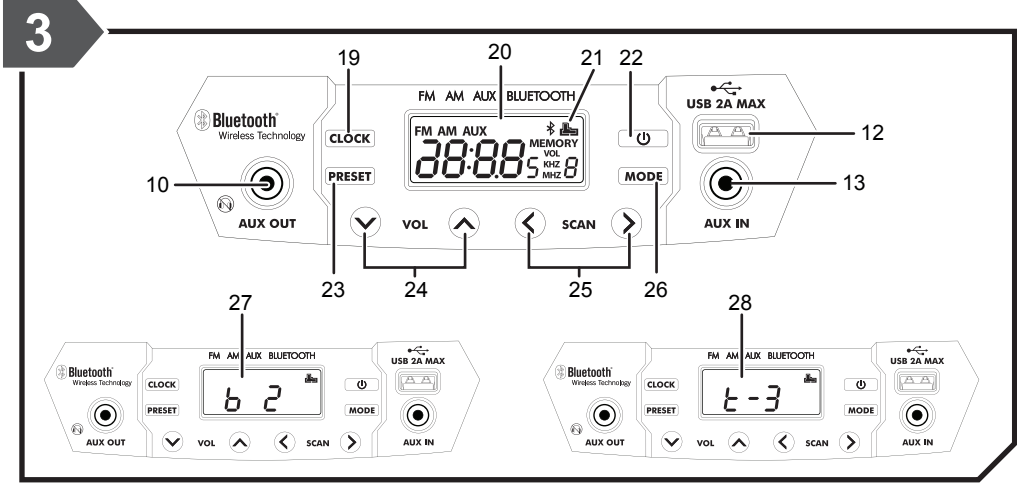
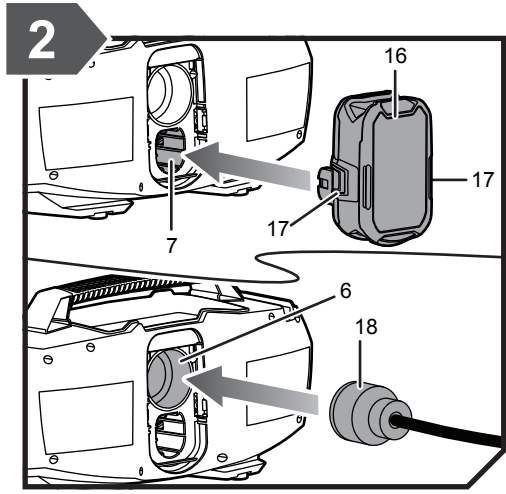
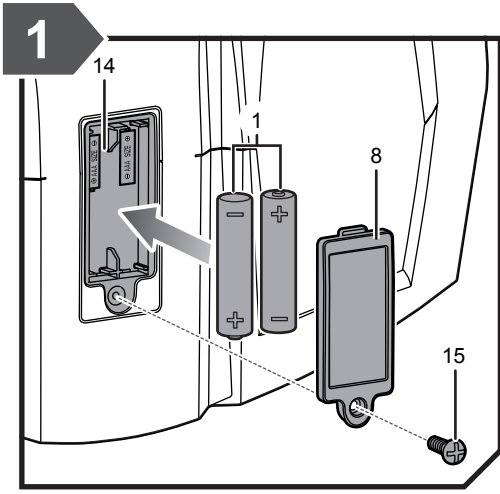

20200522v5



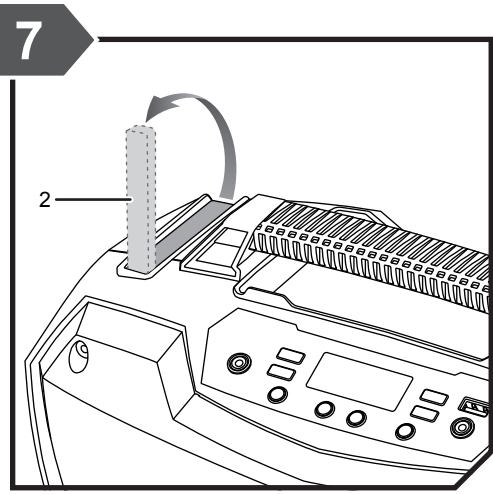
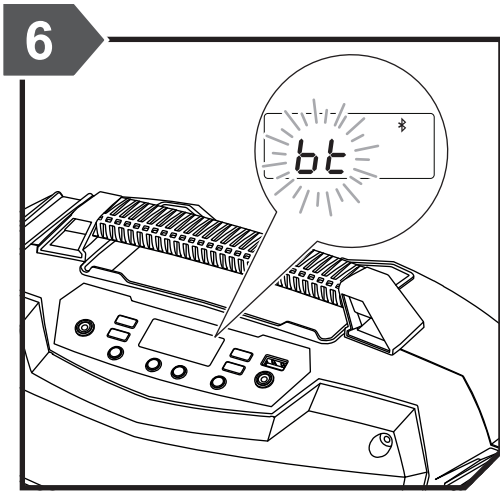
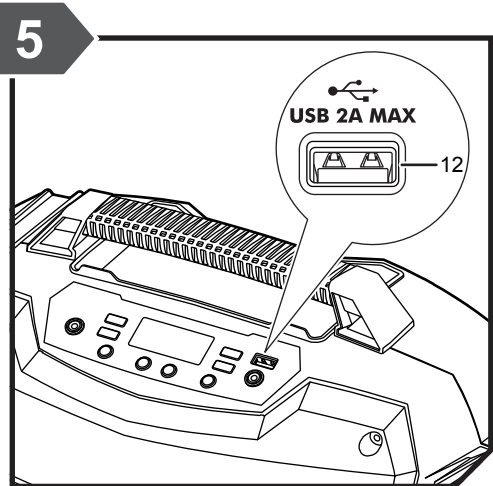
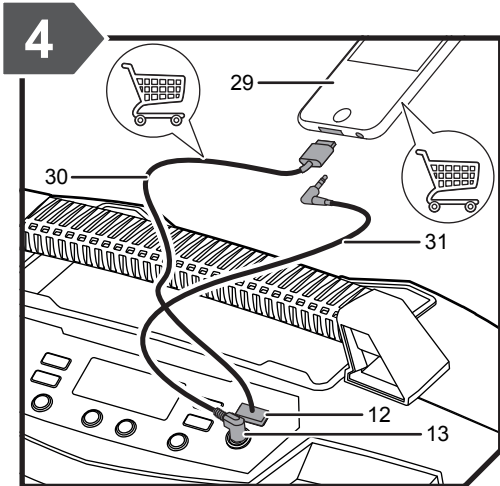

PRODUCT SPECIFICATIONS

18V ONE+ Hybrid Radio

Model	R18HR
Voltage	18 V $\overline{\text{---}}$ 220 - 240V \sim 50Hz
Rated power	40 W
AM tuner	522 - 1620 kHz
FM tuner	87.5 - 108.00 MHz
Bluetooth pairing distance	10 m
USB charging	
Output	5 V
Maximum output current	2A

BATTERY AND CHARGER

Model	Compatible battery pack (not included)	Compatible charger (not included)
Lithium-Ion	RB18L13	BCS618G BCL14181H BCL14183H BCL1418IV* RC18150U RC18627U RC18120 RC18115
	RB18L15	
	RB18L15A	
	RB18L20	
	RB18L20A	
	RB18L25	
	RB18L25A	
	RB18L40	
	RB18L40A	
	RB18L50	
RB18L50A		
RB18L60A		
RB18L90A		

* for vehicles with 12V DC outlets

BLUETOOTH LICENSE STATEMENT

The BLUETOOTH word mark and logos are registered trademarks owned by Bluetooth SIG, Inc. Other trademarks and trade names are those of their respective owners.

Imported by:

Techtronic Industries Australia Pty Ltd
31 Gilby Road, Mount Waverley,
VIC, 3149, Australia

Techtronic Industries N.Z. Limited
Unit C, 70 Business Parade South,
Highbrook, Auckland 2013, New Zealand

*RYOBI is a trade mark of Ryobi Limited,
and is used under license.*
© 2020 Techtronic Cordless GP.